

WALWORTH COUNTY
SURVEYING & MAPPING
LAKE GENEVA, WISCONSIN

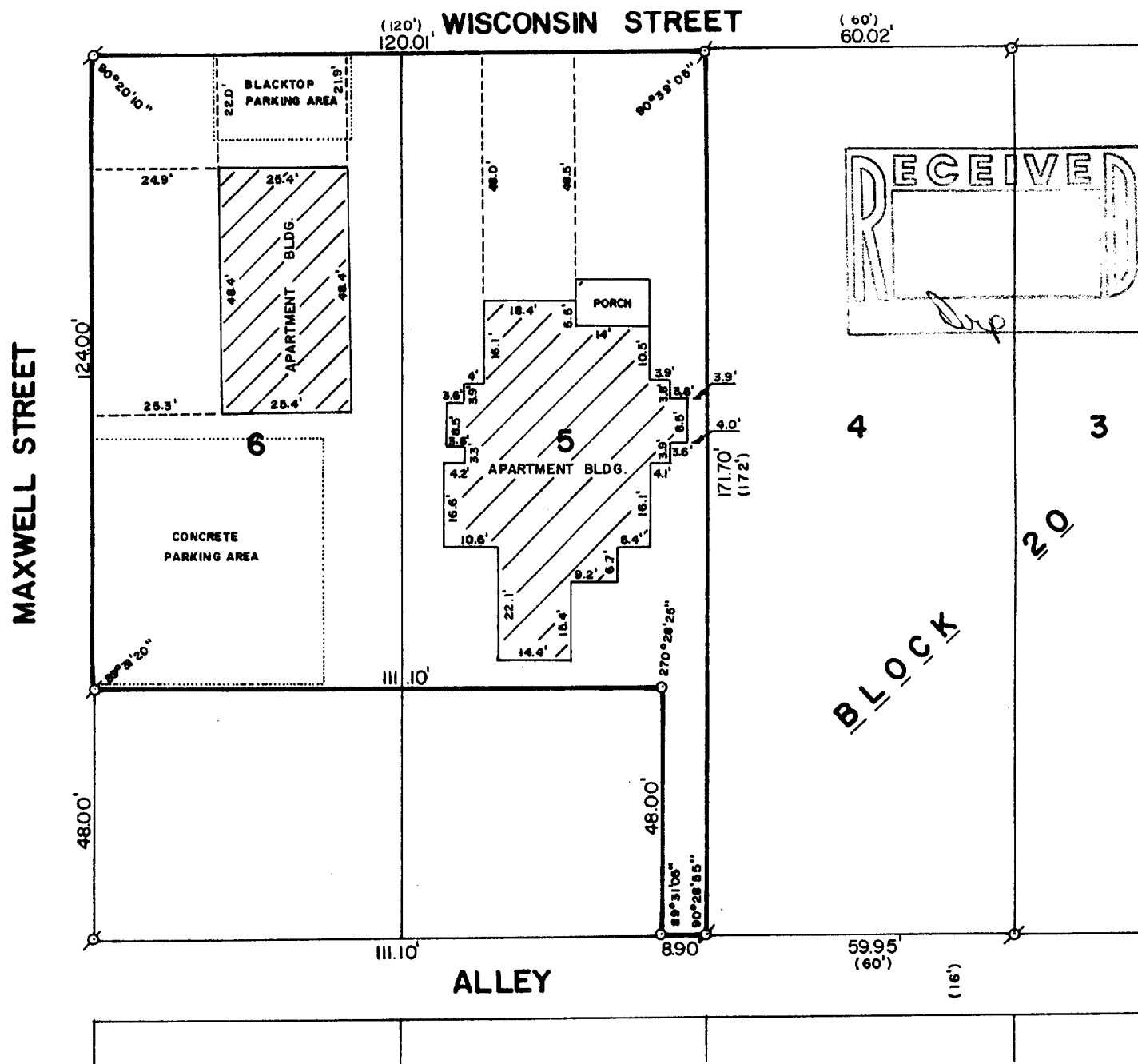

PLAT OF SURVEY OF

All of those certain Lots or parcels of land situated and being in the City of Lake Geneva in Walworth County, State of Wisconsin, known and distinguished as Lots Five (5) and Six (6), in Block numbered Twenty (20) according to the original Village Plat of Geneva, recorded in the office of the Register of Deeds in and for said County of Walworth, except the following described parcel thereof, to-wit: The South 48 feet of Lots 5 and 6 in Block 20 of the Original Plat of the City of Lake Geneva, Walworth County, Wisconsin, except the East 8.9 feet of the South 48 feet of the said Lot 5 in Block 20 of the Original Plat of the City of Lake Geneva, Walworth County, Wisconsin, subject to a right of way, for purposes of ingress and egress only to the real estate above described, in, along and across the South 48 feet of the East 8.9 feet of the aforesaid Lot 5 in Block 20.

ORDERED BY: REALTY WORLD-TAGGART
736 MAIN STREET
LAKE GENEVA, WISCONSIN 53147



SCALE: 1"=30

⊕ - IRON PIPE FOUND
○ - IRON ROD PLACED
() - RECORDED AS

I, ROBERT M. BAERENWALD, DO HEREBY CERTIFY THAT I HAVE SURVEYED THE PROPERTY HEREON DESCRIBED ACCORDING TO THE OFFICIAL RECORDS AND THAT THE PLAT HEREON IS A CORRECT REPRESENTATION OF THE PROPERTY LINES TO THE BEST OF MY KNOWLEDGE AND BELIEF.

Robert M. Baerenwald
ROBERT M. BAERENWALD
WISCONSIN REGISTERED LAND SURVEYOR, S-1508

DATE *Dec. 9, 1986* JOB NO. 0864

NOTE: THIS IS NOT A CERTIFIED COPY UNLESS SEALED.

208-190

7-8928